



**MEQUIL**

REDUTOR  
HELICOIDAL 2 ESTÁGIOS

MEQUIL



# REDUTORES A ENGRENAGENS HELICOIDAIS - LINHA H1000

## CAPACIDADES A 1750 RPM NA ENTRADA

TIPO	REDUÇÃO	6,3	7,1	8	9	10	11,2	12,5	14	16	18	20	22,4	25	28	31,5	35,5	40	45
H20	POTÊNCIA (CV)	18.1	15.7	13.6	11.9	10.5	9.1	8.0	7.0	6.0	5.2	4.6	4.0	3.5	3.1	2.7	2.3	2.0	1.7
	RED. EFETIVA	6.3	7.0	8.1	9.1	9.9	11.2	12.7	13.8	15.8	18.2	19.8	23.7	25.7	27.6	30.0	33.2	39.8	44.9
	TORQUE (Kgfm)	45	43	43	42	41	40	40	38	37	37	36	37	35	33	31	29	30	29
H21	POTÊNCIA (CV)	42.4	35.8	30.2	25.5	22.0	18.7	16.0	13.6	11.2	9.5	8.2	7.0	6.0	5.1	4.3	3.6	3.0	2.6
	RED. EFETIVA	6.5	7.0	7.8	8.8	10.1	11.4	12.8	13.9	16.0	18.4	20.0	23.0	25.0	27.5	30.0	36.0	39.8	45.0
	TORQUE (Kgfm)	108	98	92	88	87	83	80	74	70	68	64.0	63	58	55	50	50	46	45
H22	POTÊNCIA (CV)	72.0	60.4	50.6	42.5	36.4	30.7	26.1	22.1	18.1	15.2	13.0	11.0	9.4	7.9	6.7	5.6	4.7	3.9
	RED. EFETIVA	6.4	7.1	7.9	9.1	10.2	11.8	12.5	14.1	16.2	18.4	20.0	22.9	25.0	27.5	30.0	35.2	41.5	45.9
	TORQUE (Kgfm)	180	167	156	151	145	141	127	122	114	109	101	98	92	85	78	74	75	69
H23	POTÊNCIA (CV)	114.0	95.6	80.1	67.3	57.6	48.8	41.5	35.1	28.8	24.2	20.7	17.5	14.9	12.6	10.6	8.9	7.4	6.3
	RED. EFETIVA	6.3	7.1	8.0	8.6	10.5	11.3	12.7	13.7	15.6	17.9	20.3	22.4	25.4	29.7	33.6	34.5	40.4	44.8
	TORQUE (Kgfm)	280	265	250	226	236	215	206	188	175	169	164	153	148	146	139	120	117	110
H24	POTÊNCIA (CV)	172.4	145.6	122.7	103.2	89.7	76.1	64.8	55.0	45.2	38.1	32.7	27.7	23.6	20.0	16.9	14.2	11.9	10.0
	RED. EFETIVA	6.2	7.1	8.0	8.9	10.6	11.9	12.6	14.0	16.1	18.2	21.2	22.1	25.7	26.5	30.8	36.0	40.0	44.8
	TORQUE (Kgfm)	420	406	385	361	371	353	318	300	286	270	270	239	236	208	203	200	186	175
H25	POTÊNCIA (CV)	247.6	212.6	182.6	155.2	132.3	112.6	99.1	84.2	69.5	58.7	50.5	42.9	36.6	31.1	26.3	22.1	18.7	15.8
	RED. EFETIVA	6.2	7.1	8.0	8.9	10.5	11.7	12.4	13.8	15.8	18.0	19.6	21.5	23.4	28.1	30.7	35.5	39.2	43.0
	TORQUE (Kgfm)	603	593	573	543	545	517	479	453	428	412	386	360	334	341	315	306	286	265
H26	POTÊNCIA (CV)	347.6	298.7	257.8	222.3	196.1	170.3	147.2	125.3	103.7	87.7	75.6	64.3	55.1	46.9	39.7	33.5	28.3	23.9
	RED. EFETIVA	5.7	6.9	7.5	8.4	10.3	11.5	13.0	14.9	17.1	18.4	21.4	22.2	25.8	28.0	32.5	35.4	43.1	46.7
	TORQUE (Kgfm)	778	809	759	733	793	769	746	728	691	629	631	557	554	512	503	463	476	435
H27	POTÊNCIA (CV)	466.7	406.4	352.8	305.7	273.6	240.1	209.8	180.7	149.7	126.9	109.4	93.3	79.9	68.2	57.8	48.8	41.3	35.0
	RED. EFETIVA	6.1	7.2	8.1	9.2	10.0	11.3	12.2	14.0	16.0	17.6	19.4	22.3	24.6	28.0	30.8	36.0	39.8	45.0
	TORQUE (Kgfm)	1118	1150	1122	1104	1074	1065	1005	987	934	871	828	811	767	745	694	685	641	614
H28	POTÊNCIA (CV)	607.5	537.3	472.3	411.1	367.7	325.7	290.3	250.3	209.7	177.9	153.5	131.0	112.4	95.9	81.4	68.9	58.3	49.4
	RED. EFETIVA	6.2	7.2	8.1	9.2	10.9	12.4	13.4	15.2	17.6	19.3	21.0	23.0	25.0	28.0	30.5	36.1	39.9	45.1
	TORQUE (Kgfm)	1479	1520	1503	1485	1574	1586	1528	1494	1439	1338	1257	1175	1096	1047	968	970	907	869
H29	POTÊNCIA (CV)	805.4	707.0	616.5	541.5	486.5	427.6	382.5	333.2	288.1	244.7	211.5	—	155.3	132.7	112.7	95.5	81.0	68.8
	RED. EFETIVA	6.2	7.1	7.6	8.3	10.4	11.4	12.9	14.1	16.3	17.8	21.4	—	25.8	27.0	32.5	36.1	41.0	45.5
	TORQUE (Kgfm)	1961	1972	1840	1765	1987	1915	1938	1840	1831	1699	1765	—	1560	1397	1428	1344	1295	1221

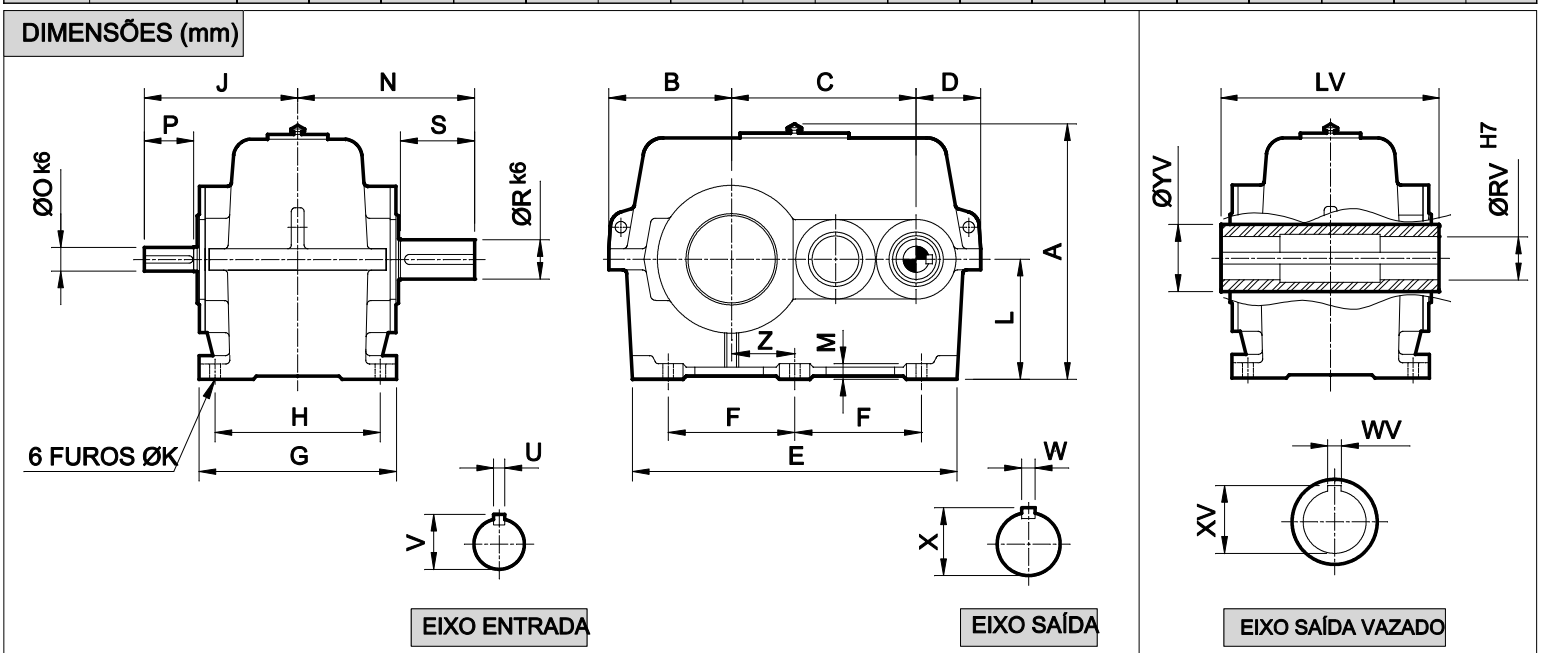

TIPO	A	B	C	D	E	F	G	H	J	ØK	L	M	N	ØO	P	ØR	S	U	V	W	X	Z	LV	RV	WV	XV	YV	PESO
H20	215	122	171	72	313	115	180	150	135	13	102	16	162	18	40	38	65	6	20,5	10	41	65	197	25	8	28,3	40	48
H21	268	133	192	81	358	139	217	180	165	13	130	19	198	22	45	42	80	6	24,5	12	45	69,5	243	30	8	33,3	45	65
H22	305	154	215	93	403	154	240	201	176	13	146	23	215	24	50	48	90	8	27,0	14	51,5	77	254	35	10	38,3	60	92
H23	333	175	240	94	450	170	257	222	185	13	160	25	235	28	50	55	100	8	31,0	16	59	80	276	40	12	43,3	60	110
H24	380	183	272	114	506	189	284	238	215	17	185	30	268	32	65	65	120	10	35,0	18	69	106	303	50	14	53,8	70	152
H25	405	208	305	124	564	212	317	267	235	17	200	33	305	38	70	75	140	10	41,0	20	79,5	109	334	55	16	59,3	80	200
H26	430	240	340	136	620	230	340	275	258	17	205	37	332	42	80	80	155	12	45,0	22	85	125	354	65	18	69,4	90	270
H27	480	274	385	135	685	253	405	345	290	22	234	42	372	48	90	90	170	14	51,5	25	95	125	404	75	20	79,9	100	370
H28	510	303	430	148	765	285	415	364	340	22	250	50	421	50	120	100	200	14	53,5	28	106	137	443	80	22	85,4	110	475
H29	619	348	480	173	867	320	471	405	374	25	293	60	465	60	130	110	220	18	64,0	28	116	152	490	85	22	90,4	120	660

FATOR DE VELOCIDADE FV (POT. EQUIV.=POT TABELA x FV)	rpm	1500	1200	900	600	300	100
FV		0,87	0,71	0,6	0,43	0,2	0,1

# REDUTORES A ENGRENAGENS HELICOIDAIS - LINHA H1000

## FLANGE PARA MOTORES

FORMA 1 A 9

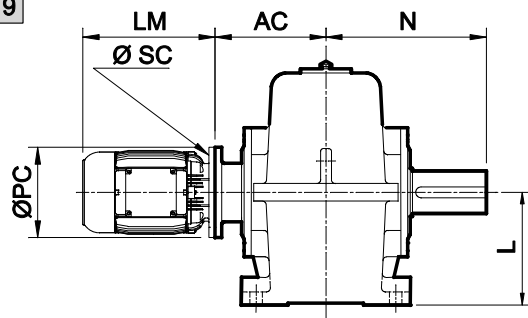

FORMAS 10-11-12-13

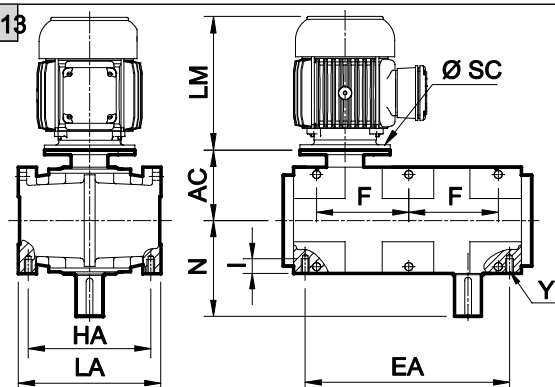

REDUTOR TIPO	MOTOR		N	FLANGE "A" OU "C-DIN"			FLANGE "F"			FORMA 10 OU 11						
	CARÇAÇA	LM		TIPO	AC	PC	SC	TIPO	AC	PC	SC	HA	LA	EA	Y	I
H20	80	234	162	C120-20	138	120	6.5	F165-20	212	200	12	176	204	281	M12	28
	90	276		C140-20	147	140	8.5	F165-20	212	200	12					
	100/112	327.5		C160-20	140	160	8.5	F215-20	238	250	15					
	132*	410.5		—	—	—	—	F265-20	259	300	15					
H21	90	276	198	C140-21	163	140	8.5	F165-21	240	200	12	236	260	328	M12	30
	100/112	327.5		C160-21	158	160	8.5	F215-21	263	250	15					
	132*	410.5		—	—	—	—	F265-21	274	300	15					
H22	90	276	215	C140-22	163	140	8.5	F165-22	254	200	12	260	292	360	M12	30
	100/112	327.5		C160-22	158	160	8.5	F215-22	275	250	15					
	132*	410.5		C200-22	178	200	10.5	F265-22	286	300	15					
H23	100/112	327.5	235	C160-23	178	160	8.5	F215-23	271	250	15	284	320	416	M12	30
	132	410.5		C200-23	178	200	10.5	F265-23	293	300	15					
	160*	533		—	—	—	—	F300-23	346	350	19					
	180*	571		—	—	—	—	F300-23	346	350	19					
H24	100/112	327.5	268	C160-24	181	160	8.5	F215-24	295	250	15	324	370	460	M16	32
	132	410.5		C200-24	198	200	10.5	F265-24	319	300	15					
	160	533		—	—	—	—	F300-24	370	350	19					
	180*	571		—	—	—	—	F300-24	370	350	19					
H25	100/112	327.5	305	A215-25	206	250	15	F215-25	325	250	15	359	400	520	M16	32
	132	410.5		C200-25	206	200	10.5	F265-25	344	300	15					
	160	533		—	—	—	—	F300-25	384	350	19					
	180	571		—	—	—	—	F300-25	384	350	19					
H26	132	410.5	332	C200-26	213	200	10.5	F265-26	370	300	15	350	410	560	M16	32
	160	533		A300-26	232	350	19	F300-26	401	350	19					
	180	571		A300-26	232	350	19	F300-26	401	350	19					
	200*	627		A350-26	232	400	19	F350-26	402	400	19					
H27	132	410.5	372	C200-27	257	200	10.5	F265-27	407	300	15	410	468	622	M22	38
	160	533		A300-27	257	350	19	F300-27	438	350	19					
	180	571		A300-27	257	350	19	F300-27	438	350	19					
	200*	627		A350-27	257	400	19	F350-27	438	400	19					
	225*	667		A400-27	257	450	19	F400-27	438	450	19					
	—	—		—	—	—	—	—	—	—	—					
H28	132	410.5	421	A265-28	257	200	10.5	—	—	—	446	500	705	M22	38	
	160	533		A300-28	276	350	19	F300-28	438	350						19
	180	571		A300-28	276	350	19	F300-28	438	350						19
	200*	627		A350-28	276	400	19	F350-28	486	400						19
	225*	667		A400-28	276	450	19	F400-28	490	450						19
	—	—		—	—	—	—	—	—	—						—
H29	160	533	465	A300-29	313	350	19	F300-29	520	350	19	502	586	795	M22	52
	180	571		A300-29	313	350	19	F300-29	520	350	19					
	200*	627		A350-29	313	400	19	F350-29	522	400	19					
	225*	667		A400-28	313	450	19	F400-29	531	450	19					
	250*	753		A500-28	313	550	19	F500-29	531	550	19					
	—	—		—	—	—	—	—	—	—	—					

## FORMAS CONSTRUTIVAS

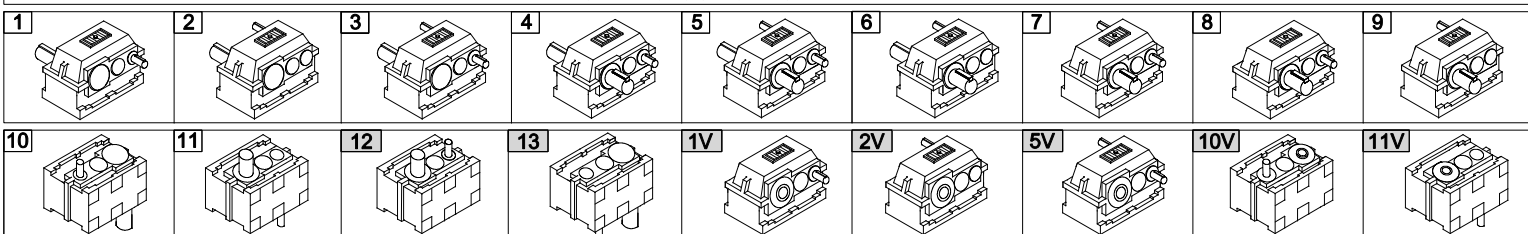

\*SOMENTE NAS FORMAS CONSTRUTIVAS 10 E 12  
OBS: INFORMAÇÕES SUJEITAS A ALTERAÇÕES SEM AVISO PRÉVIO

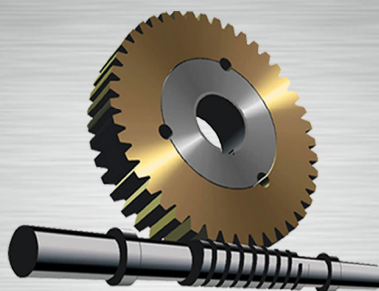

# MEQUIL

R. ARTUR ORLANDO, 20 VILA JAGUARA  
CEP 05118-000

TELEFONES: (11) 3621-3599  
FAX: (11) 3625-1747

RH - MEQUIL@MEQUIL.COM.BR  
VENDAS@MEQUIL.COM.BR

[WWW.MEQUIL.COM.BR](http://WWW.MEQUIL.COM.BR)

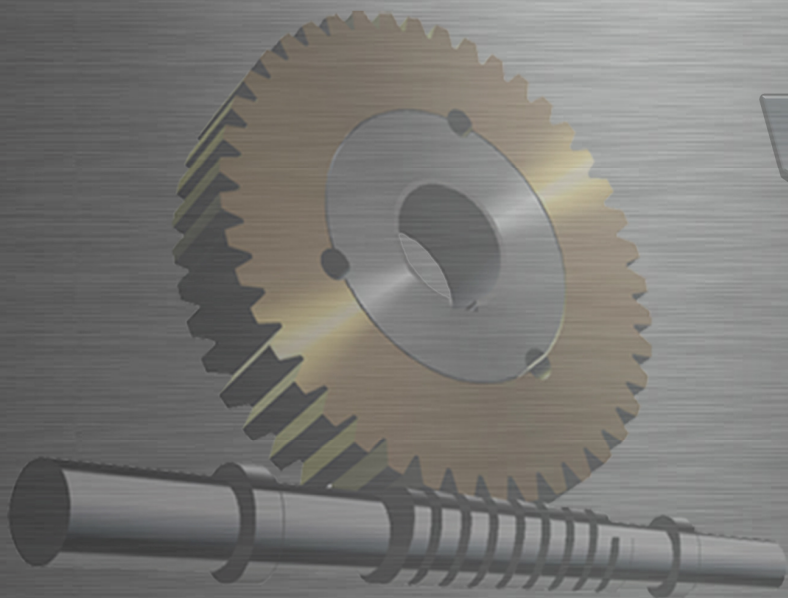

# MEQUIL